

78 Pin Configuration
(Customizable)

22 AWG Mil-Spec Wire
(Customizable)

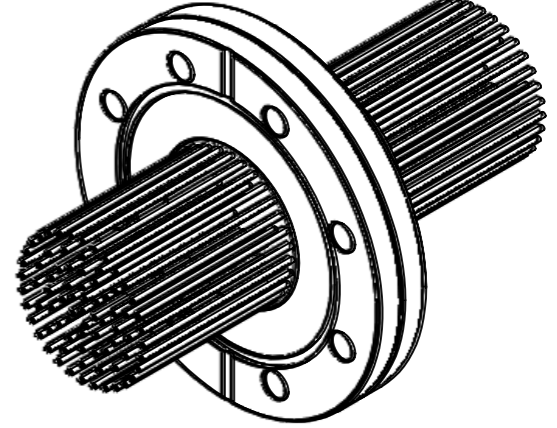
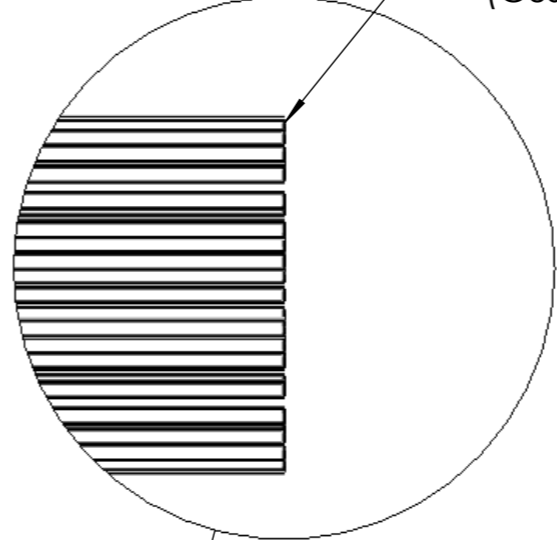
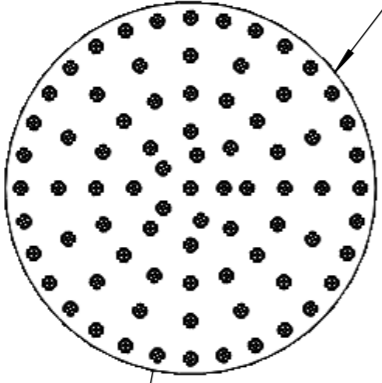

DETAIL A
SCALE 1:1

DETAIL B
SCALE 1:1

ISOMETRIC VIEW

O-ring Groove

304L SS CF Flange
(Engineered for your application)

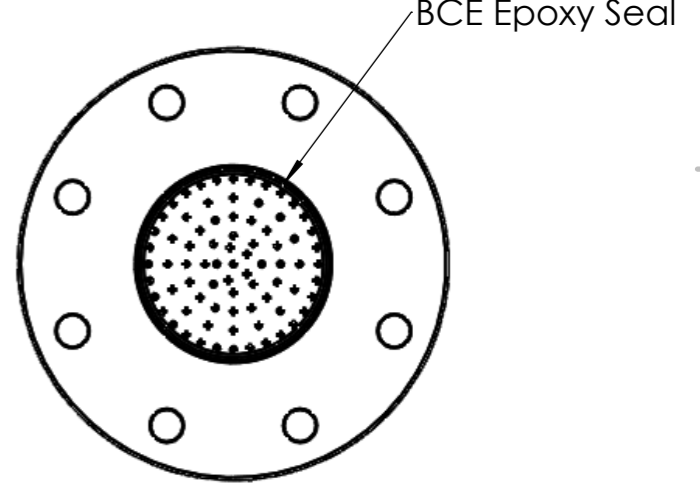
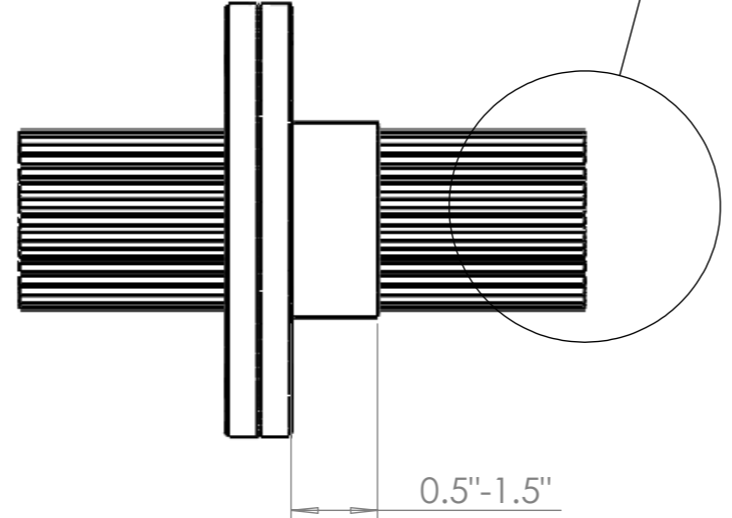
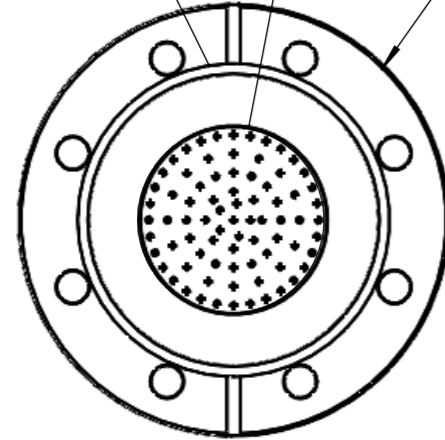

Vacuum Side

Atmosphere Side

NOTES

1. Helium Leak Test: 10^{-6} Torr
2. Temperature: Application Specific
3. BCE Epoxy:
 - a. Outgassing: meets NASA ASTM E595
 - b. Total Mass Loss (TML): <1.0%
 - c. Collected Volatile Condensable Materials: <0.1%
 - d. Dielectric Constant (1 KHz): 3.8
5. Length and type of leads to customer specifications

UNLESS OTHERWISE SPECIFIED: DIMENSIONS ARE IN MILLIMETERS		FINISH:		DEBURR AND BREAK SHARP EDGES		DO NOT SCALE DRAWING		REVISION	
SURFACE FINISH:									
TOLERANCES:									
LINEAR:									
ANGULAR:									
DRAWN		NAME		SIGNATURE		DATE		TITLE:	
CHK'D		FATIMA SYED				10/24/16		Multi-Input Vacuum Feedthrough	
APPV'D								DWG NO.	
MFG								MHC4807	
Q.A								A3	
								SCALE:1:2	
								SHEET 1 OF 1	