

4

3

2

1

B

B

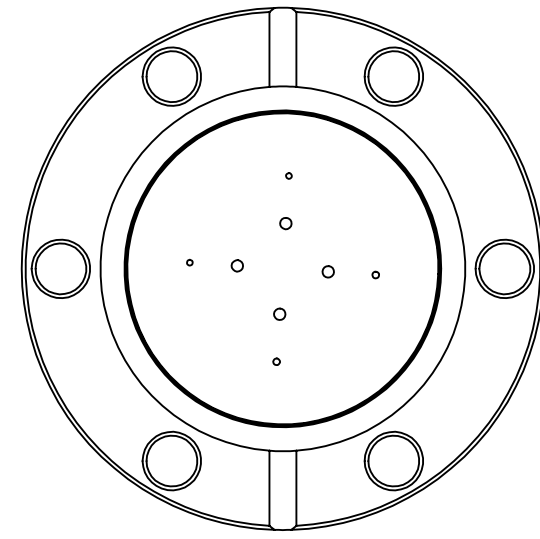

Vacuum

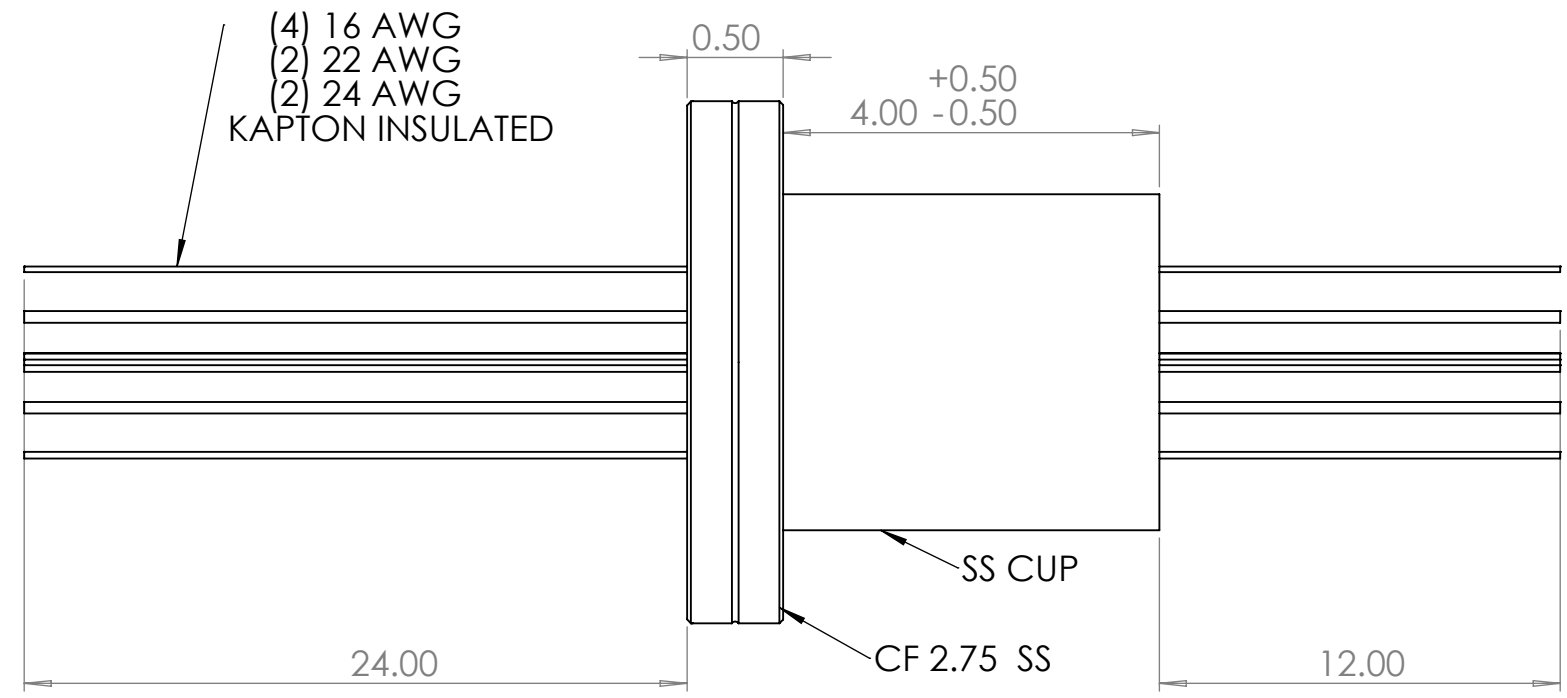

ALL LEADS WILL BE CUT APPROX 1-3 INCHES LONGER

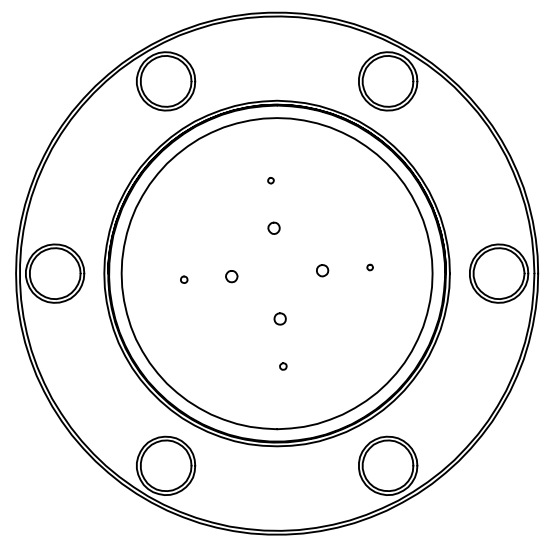
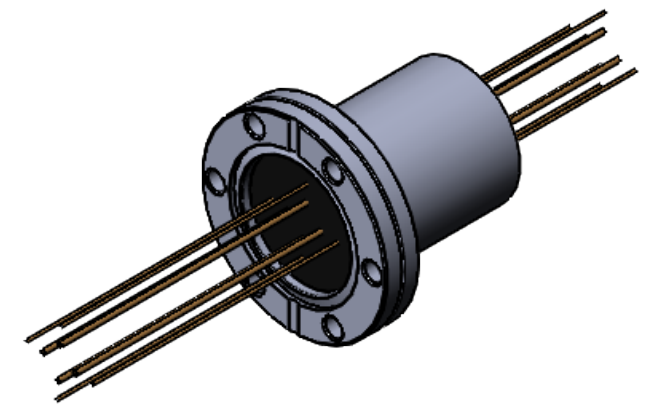

Atmosphere

A

A

NOTES:

1. CHAMBER CORE TEMPERATURE MAX : 250 C
2. FLANGE/SEAL MAXIMUM EXPOSURE TEMPERATURE: 125 C 1-1.5 HRS
3. VACCUM LEAK RATING: 10^{-7} ATM-CC/SEC
4. LEADS WILL BE TERMINATED WITH BARE #10 RING TERMINALS. (**NOT SHOWN IN VISUAL**)
5. LEADS WILL BE LABELED ON ATMOSPHERE SIDE.

PROPRIETARY AND CONFIDENTIAL
 THE INFORMATION CONTAINED IN THIS DRAWING IS THE SOLE PROPERTY OF BELILOVE CO. ENGINEERS. ANY REPRODUCTION IN PART OR AS A WHOLE WITHOUT THE WRITTEN PERMISSION OF BELILOVE CO. ENGINEERS IS PROHIBITED.

UNLESS OTHERWISE SPECIFIED:		NAME	DATE	BCE
DIMENSIONS ARE IN INCHES		DRAWN	A.M	
TOLERANCES:		CHECKED		
FRACTIONAL ±		ENG APPR.		
ANGULAR: MACH ± BEND ±		MFG APPR.		
TWO PLACE DECIMAL ±		Q.A.		
THREE PLACE DECIMAL		COMMENTS:		
INTERPRET GEOMETRIC TOLERANCING PER:		THIS DRAWING IS FOR REFERENCE ONLY.		
MATERIAL		FINAL PRODUCT MAY DIFFER.		
FINISH		SIZE	DWG. NO.	REV
DO NOT SCALE DRAWING		B	BCE10801	-
		SCALE: NTS	WEIGHT: N/A	SHEET 1 OF 1

4

3

2

1