

4

3

2

1

PLEASE SIGN TO APPROVE

X: _____ / _____

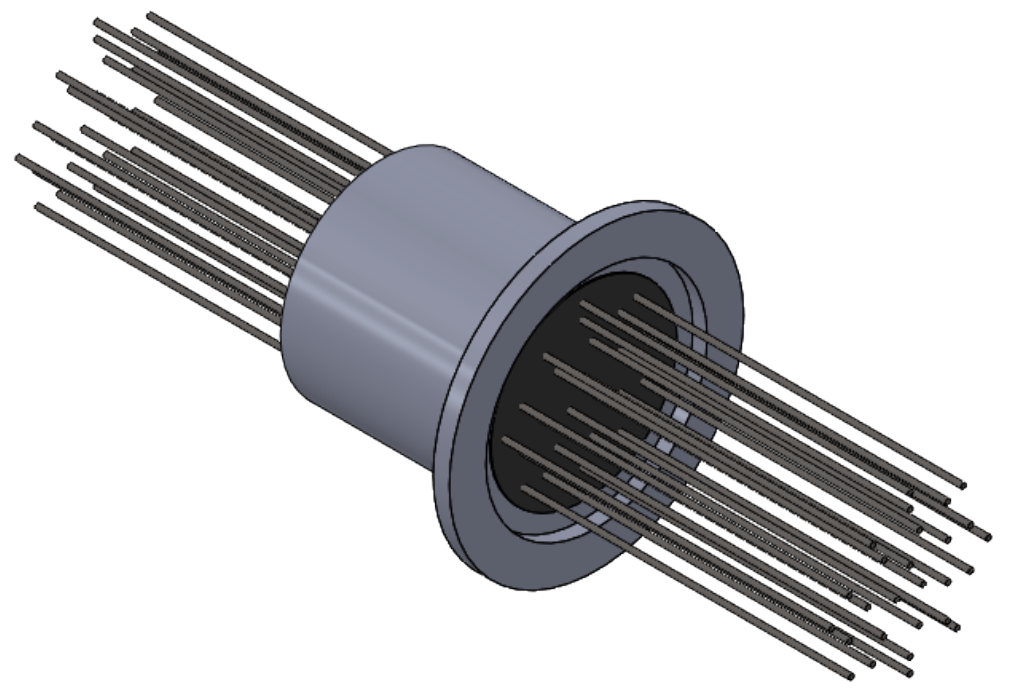

27x TEFLON INSULATED
26 AWG STRANDED WIRE

304 SS KF40 FLANGE

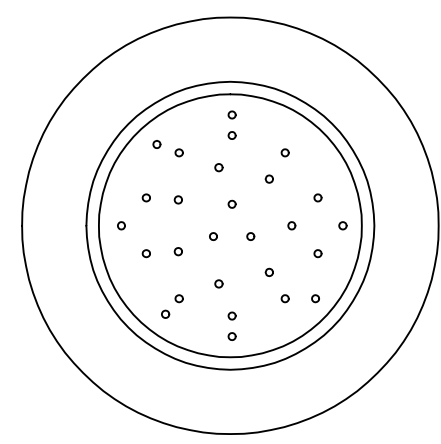

ATMOSPHERE SIDE

Ø 1.50

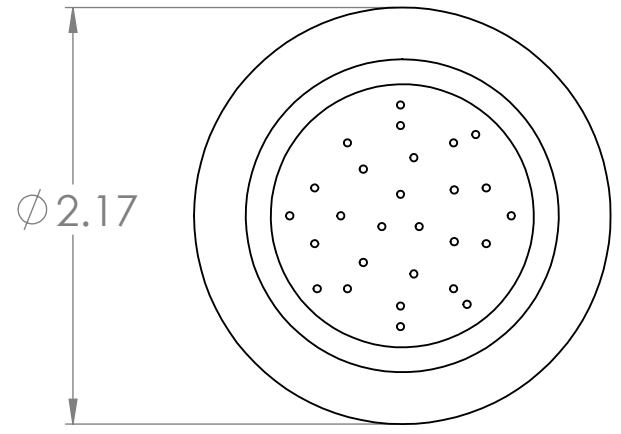
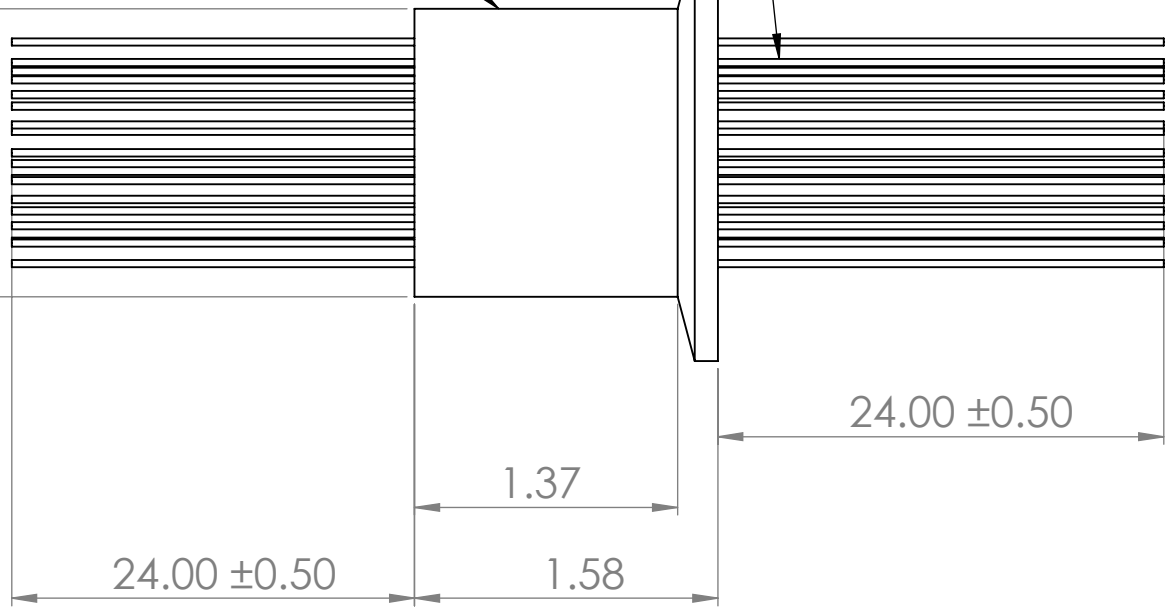

VACUUM SIDE

Ø 2.17

B

B

A

A

NOTES:

1. OPERATING TEMPERATURES: -20C TO 50C
2. VACUUM LEAK RATE: 10^{-7} ATM-CC/SEC W/HELIUM

UNLESS OTHERWISE SPECIFIED:
 DIMENSIONS ARE IN INCHES
 TOLERANCES:
 FRACTIONAL ±1/32
 ANGULAR: MACH ± 1.0 BEND ±2.0
 TWO PLACE DECIMAL ±0.01
 THREE PLACE DECIMAL ±0.005

PROPRIETARY AND CONFIDENTIAL
 THE INFORMATION CONTAINED IN THIS DRAWING IS THE SOLE PROPERTY OF BELILOVE COMPANY ENGINEERS (BCE). ANY REPRODUCTION IN PART OR AS A WHOLE WITHOUT THE WRITTEN PERMISSION OF BELILOVE COMPANY ENGINEERS (BCE) IS PROHIBITED.

INTERPRET GEOMETRIC TOLERANCING PER:
 MATERIAL SEE DWG
 FINISH N/A
 DO NOT SCALE DRAWING



TITLE:
**KF40 27 WIRE
 26 AWG FEEDTHROUGH**

| | | |
|------------|-----------------|--------------|
| SIZE | DWG. NO. | REV |
| B | BCE11037 | - |
| SCALE: NTS | | SHEET 1 OF 1 |

4

3

2

1