

8

7

6

5

4

3

2

1

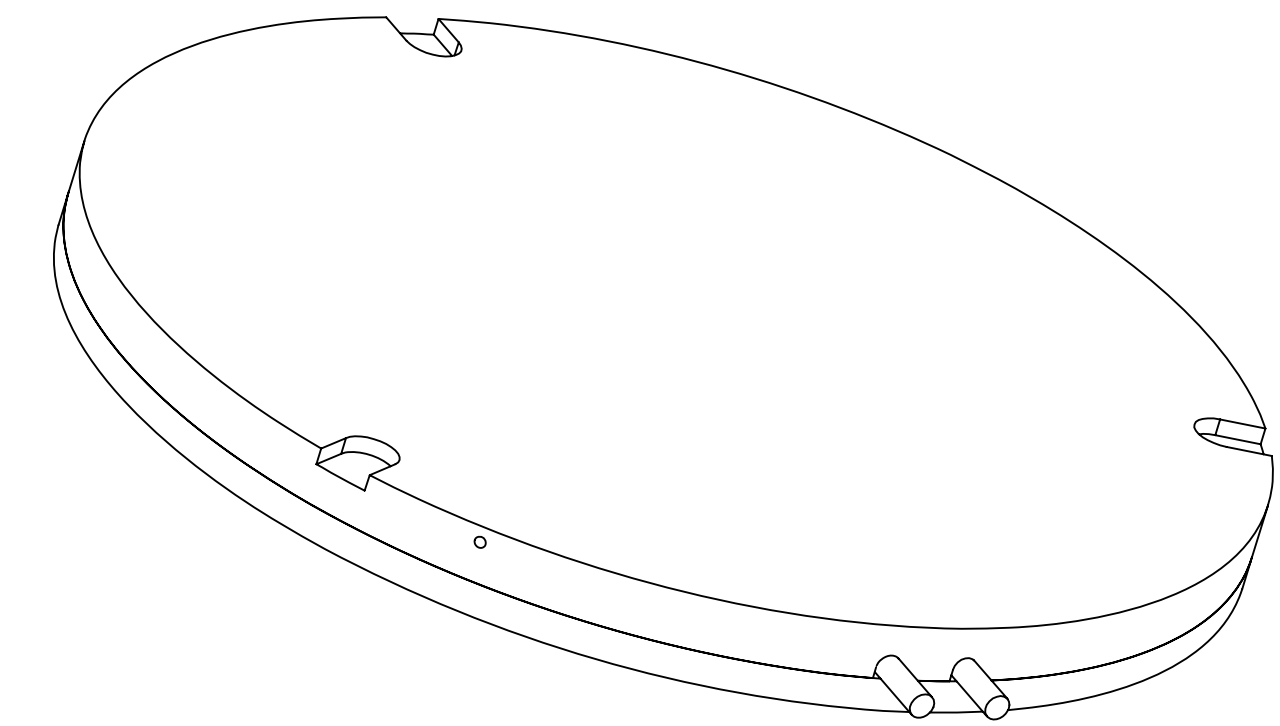
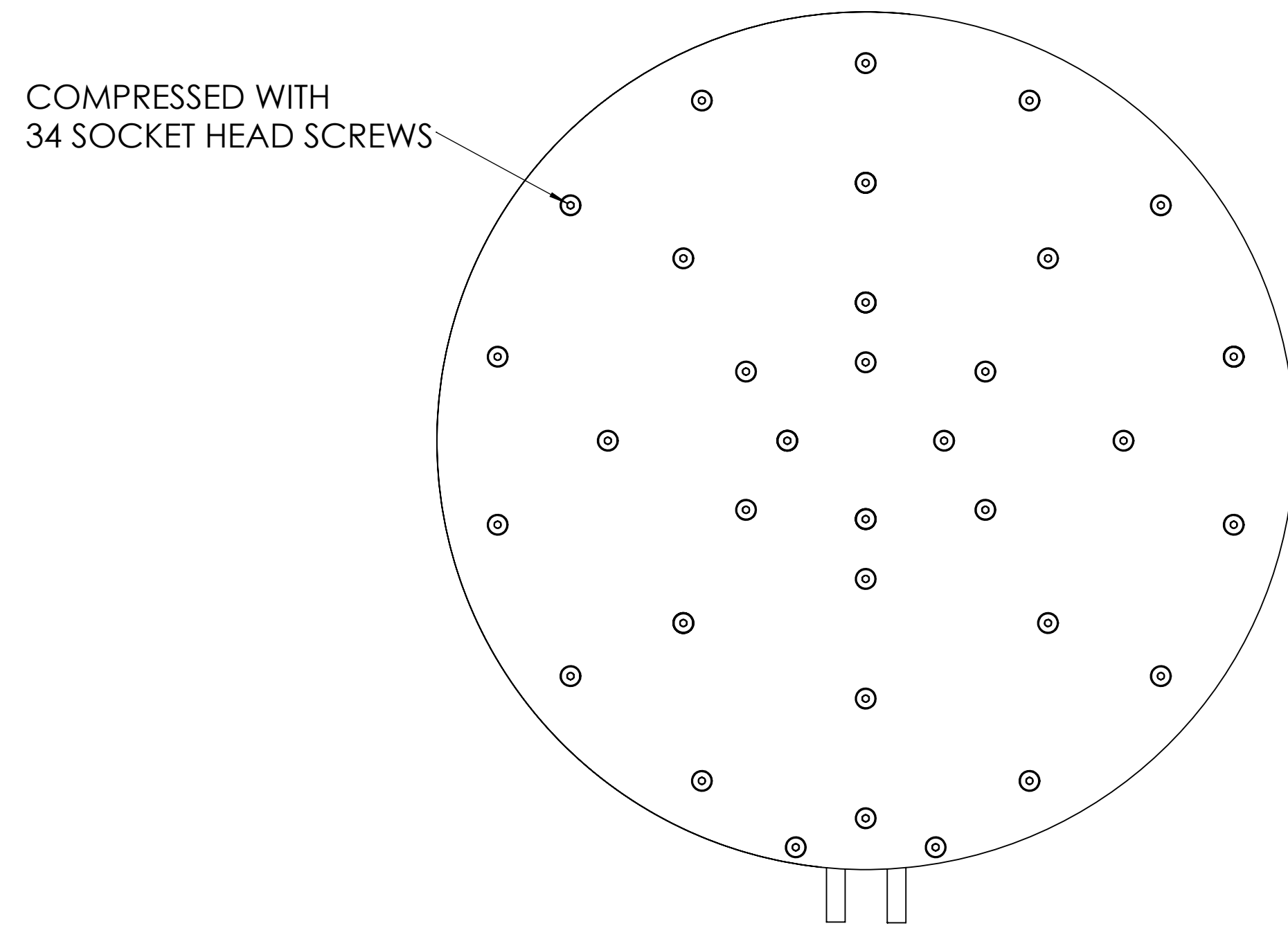
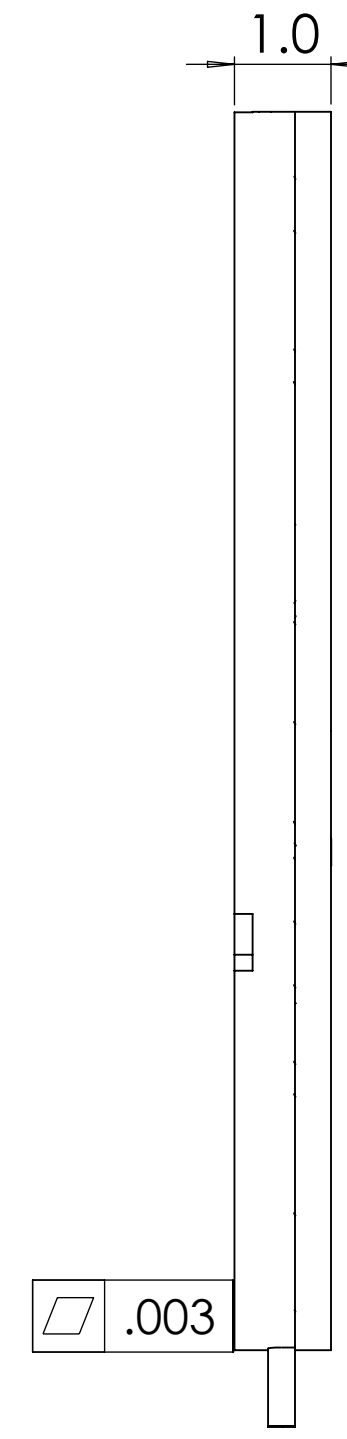
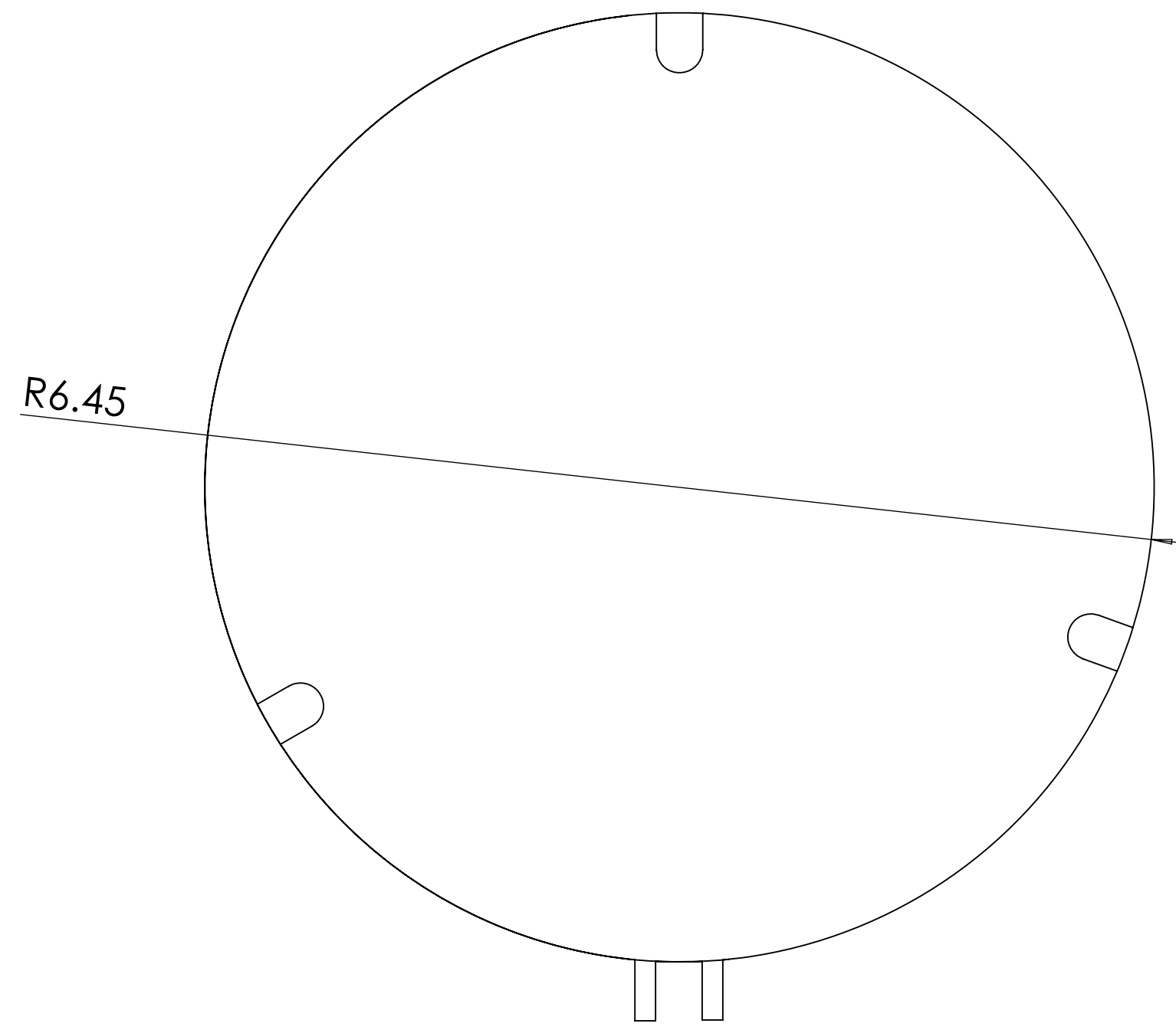

NOTES:

- 1. MATERIAL: ALUMINUM 6061, INCOLOY ELEMENT
- 2. 10-24 STAINLESS STEEL SOCKET HEAD SCREWS
- 3. 208 VOLT 4400 WATTS (+5/-10 %)
- 4. MAX TEMPERATURE 450 C
- 5. FINISH: HARD COAT ANODIZE PER MIL-A-8625F, TYPE 3, CLASS 1, HARDCOAT THICKNESS

PROPRIETARY AND CONFIDENTIAL
 THE INFORMATION CONTAINED IN THIS DRAWING IS THE SOLE PROPERTY OF [REDACTED]. ANY REPRODUCTION IN PART OR AS A WHOLE WITHOUT THE WRITTEN PERMISSION OF [REDACTED] IS PROHIBITED.

UNLESS OTHERWISE SPECIFIED:		NAME	DATE	BCE 21060 Corsair Blvd Hayward, CA 94545 TITLE: NON-BRAZED 300MM HEATER CHUCK SIZE DWG. NO. REV D BCE10949 - SCALE: NTS WEIGHT: SHEET 1 OF 1
DIMENSIONS ARE IN INCHES		DRAWN	AJM	
TOLERANCES:		CHECKED	D.S	
FRACTIONAL ±		ENG APPR.	AJM	
ANGULAR: MA CH ± BEND ±		MFG APPR.		
TWO PLACE DECIMAL ± .01		Q.A.		
THREE PLACE DECIMAL ± .005		COMMENTS:		
INTERPRET GEOMETRIC TOLERANCING PER:				
MATERIAL: AL 6061				
FINISH: SEE NOTES				
NEXT ASSY	USED ON			
APPLICATION		DO NOT SCALE DRAWING		

8

7

6

5

4

3

2

1