

4

3

2

1

B

B

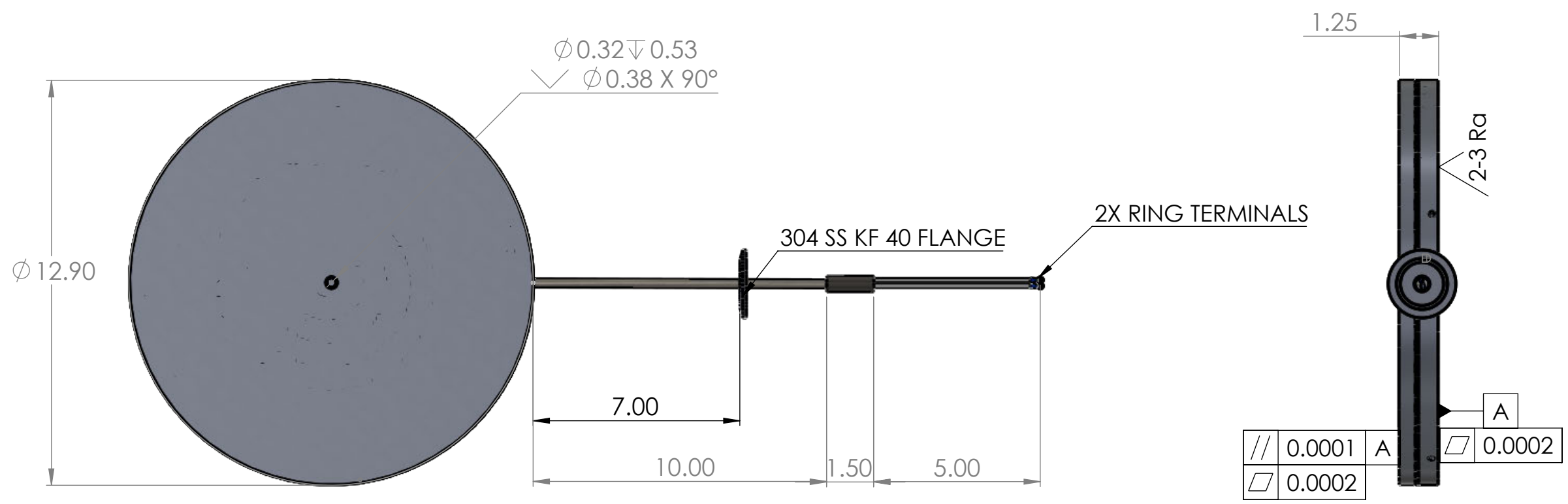

**NOTES:**

1. PERFORMANCE SPECIFICATION:

- A. MAX. OPERATING TEMPERATURE 450 C
- B. TEMPERATURE UNIFORMITY: +/-2% OF OPERATING TEMPERATURE WITHIN THE 12.25 DIA CIRCLE
- C. FLATNESS ON SURFACE -A- STAY WITHIN SPEC. PRIOR TO RAMP.
- D. NO STAINING OF ANY KIND ALLOWED AFTER HEATING.

- 2. FINISH: HARD COAT ANODIZE PER MIL-A-8625F, TYPE 3, CLASS 1, HARDCOAT THICKNESS .0020±.0004. (SEE S4 ENGINEERING BEFORE ANODIZE).
- 3. THERMAL STABILIZATION: BRAZING OPERATION PERFORMED (TEMPERORY ELECTRICAL TERMINATION REQUIRED).

4. ELECTRICAL REQUIREMENTS:

- A. 4350 WATT(+/-10% ) 208 VOLTS, 20.9 AMPS.
- B. OHMS RATING TEST: 9.9NOM 8.9 - 10.9 OHMS
- C. HIPOT/BREAKDOWN TEST: 1200 VDC, 3.5 mA FAULT CURRENT LIMIT
- D. MEGAOHM TEST: 500 VDC (20 M-OHM MIN)

5. COMPLIANCE

- A. USE ROHS COMPLIANT APPROVED MATERIAL/PART.
- B. BCE,COFC UL COMPLIANT

6. CLEANING

- A. HIGH PURITY CLEAN AND PACKAGE PER BCE# UT19 IN-HOUSE BCE (DI WATER ULTRASONIC CLEAN WITH 93 C OVEN BAKE DRY)
- B. MUST HANDLE PART WITH CLEAN GLOVES AFTER ANODIZE. ANY DIRT, GREASE, OIL, ETC. WILL STAIN THE ANODIZED SURFACE.
- C. BAG AND TAG WITH BCE PART NUMBER AND CURRENT REVISION LEVEL



TITLE:  
**300 MM HOT CHUCK  
SINGLE END**

**PROPRIETARY AND CONFIDENTIAL**  
THE INFORMATION CONTAINED IN THIS DRAWING IS THE SOLE PROPERTY OF BELILOVE COMPANY ENGINEERS (BCE). ANY REPRODUCTION IN PART OR AS A WHOLE WITHOUT THE WRITTEN PERMISSION OF BELILOVE COMPANY ENGINEERS (BCE) IS PROHIBITED.

UNLESS OTHERWISE SPECIFIED:  
DIMENSIONS ARE IN INCHES  
TOLERANCES:  
FRACTIONAL ±1/32  
ANGULAR: MACH ± 1.0 BEND ±2.0  
TWO PLACE DECIMAL ±0.01  
THREE PLACE DECIMAL ±0.005

INTERPRET GEOMETRIC TOLERANCING PER:  
MATERIAL **6061 ALUMINUM**  
FINISH **SEE DWG**  
DO NOT SCALE DRAWING

SIZE	DWG. NO.	REV
<b>B</b>	<b>BCE10745</b>	-
SCALE:NTS		SHEET 1 OF 1

4

3

2

1

A

A