

2

1

THIS DRAWING IS FOR REFERENCE ONLY

B

B

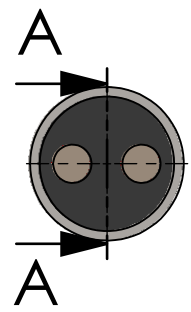
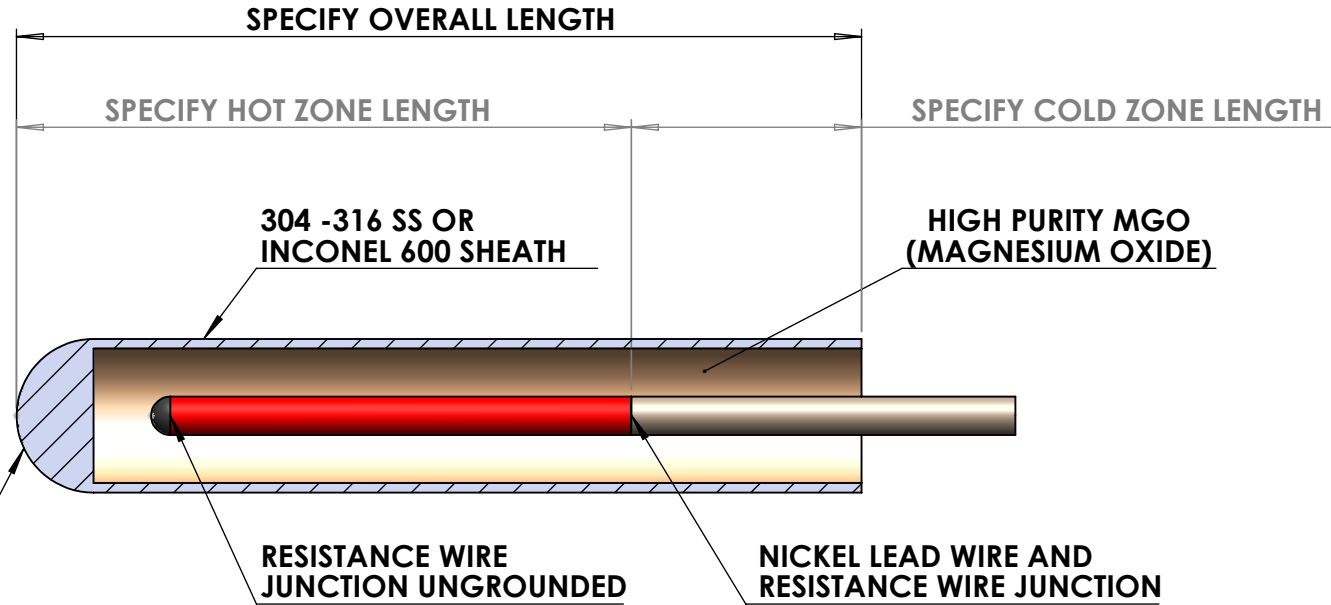

WATT DENSITY:.....75 watts per square inch max consult BCE
MAX TEMP:.....(815°C) for 304-316SS ,(982°C) for Inconel® 600 sheath
RESISTANCE:.....+/-10% unless specified otherwise
VOLTAGE:.....24VOLT, 120VOLT, 240VOLT STANDARD
THERMOCOUPLES:..... J (815°C) or K (982°C) Internal, grounded or un-grounded
DIAMETERS:040" - .250", .125" dia. minimum for Internal TC.
DIAMETER TOLERANCE:.....+/--.005"
LENGTH TOLERANCE:.....0-6" (+.125"-0"), 6-18" (+.25"-0"), 18"-24" (+.38"-0")
 24"-120" (+.75"-0"), 120 -300" (+/-1")

A

A

**SECTION A-A
SCALE NTS**



TITLE:
Cable Heater Composition and Additional Specs

PROPRIETARY AND CONFIDENTIAL
 THE INFORMATION CONTAINED IN THIS DRAWING IS THE SOLE PROPERTY OF BCE INC. ANY REPRODUCTION IN PART OR AS A WHOLE WITHOUT THE WRITTEN PERMISSION OF BCE INC. IS PROHIBITED.

SIZE	DWG. NO.	REV
A	BCE10097	A
SCALE: NTS	WEIGHT: -	SHEET 1 OF 1

2

1